

PARK COMMUNITY CHARTER

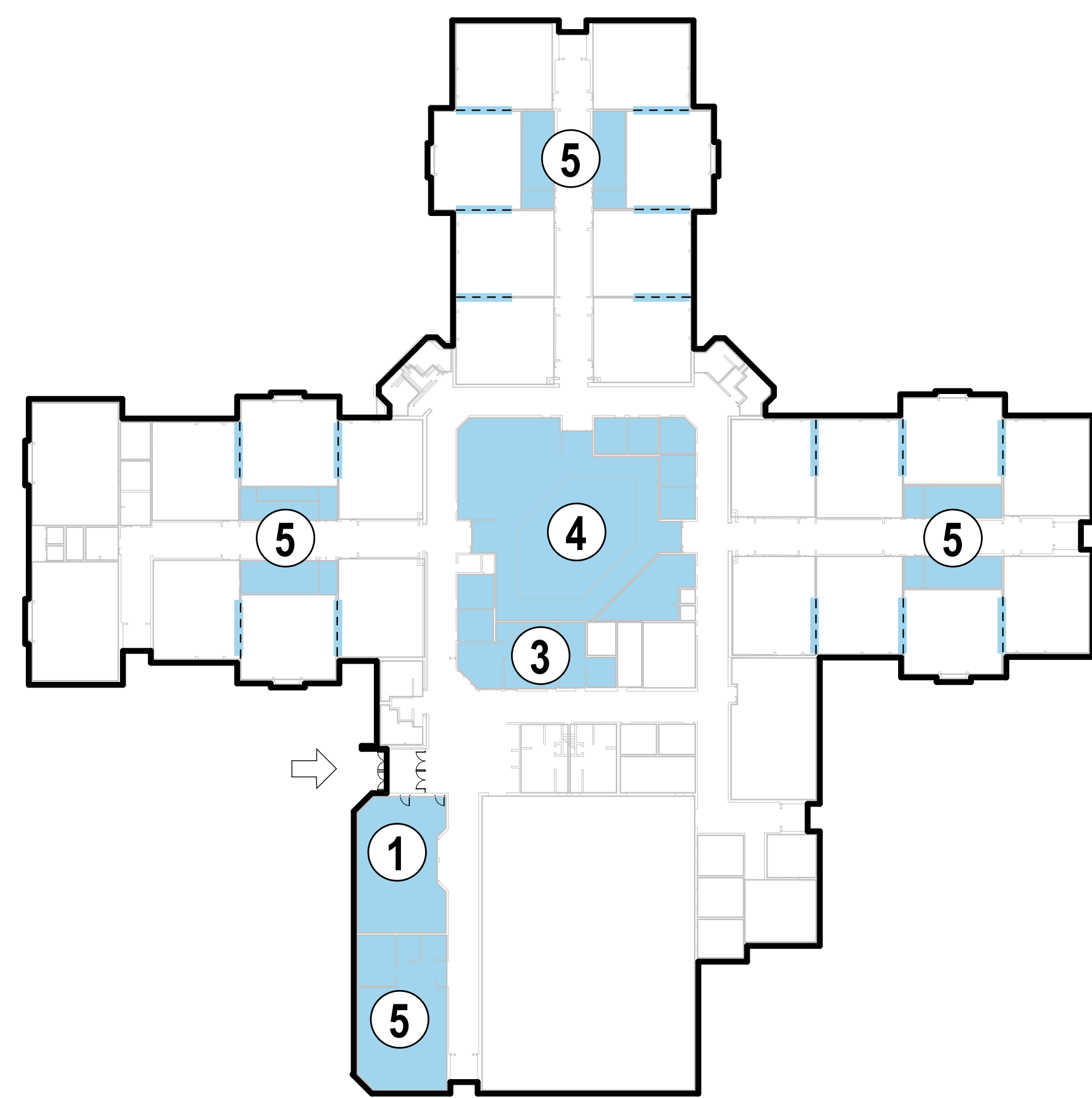

VICTOR HAEN ELEMENTARY



TANNER ELEMENTARY

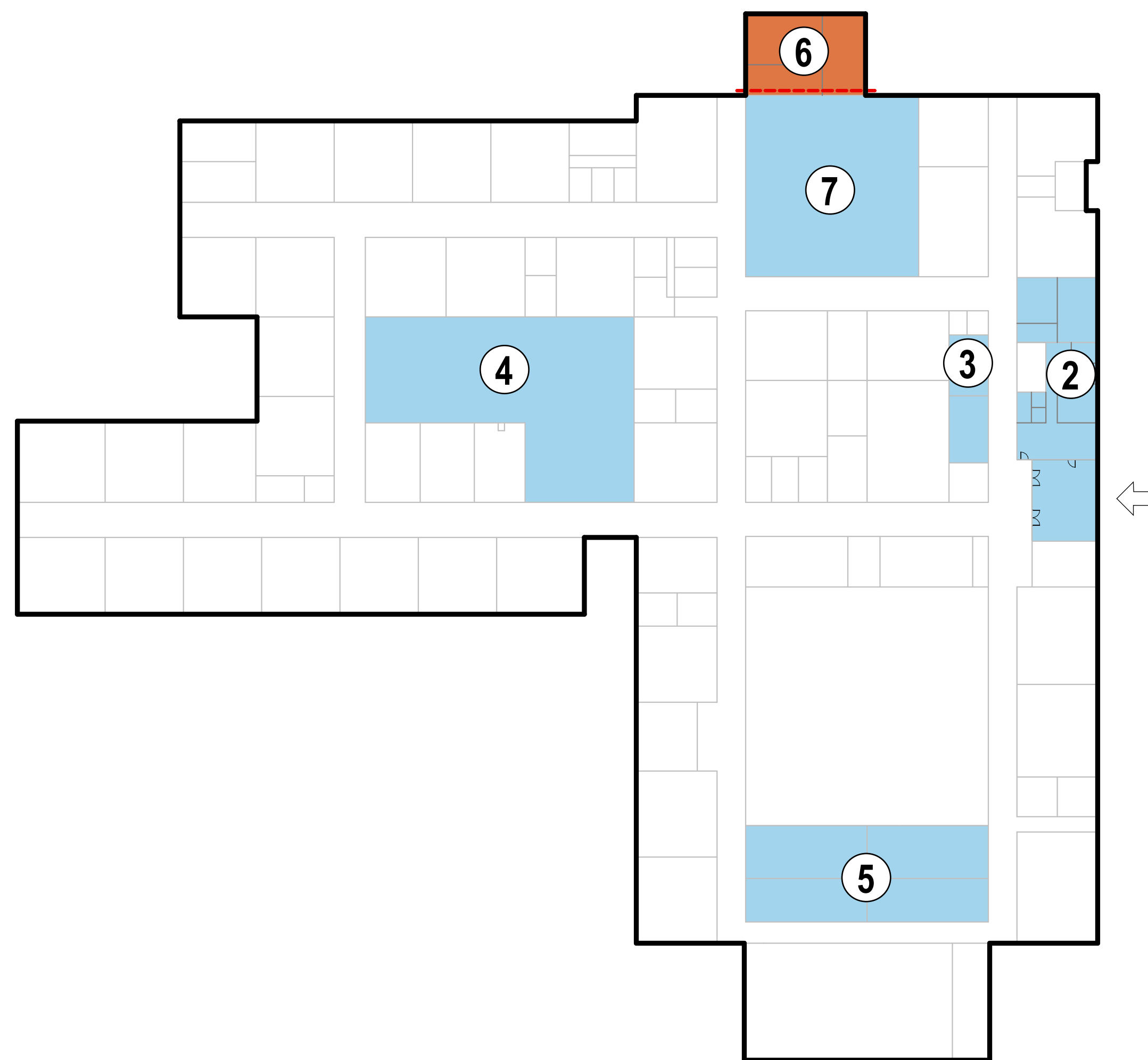

ELECTA QUINNEY /  
NEW DIRECTIONS LEARNING COMMUNITY

**GRADE-LEVEL CONFIGURATION CHANGE**  
The proposed plan includes re-alignment of all District elementary schools to ease capacity concerns, create consistency and balance student enrollment.

	Tanner	NDLC	Park	Haen	Quinney
Current Configuration	4K-1	4K-4	5K-4	1-4	2-4
Proposed Configuration	4K-4	4K-4	4K-4	4K-4	4K-4

**PROJECT LIST**

- 1) Relocate Main Offices to create more secure visitor entrances
- 2) Reconfigure EQ/NDLC Main Office to create dedicated reception/office space for both schools
- 3) Repurpose former Main Office spaces for specialist / resource space
- 4) Renovate Libraries to improve resource spaces
- 5) Remodel miscellaneous existing spaces for new functions
- 6) Create new Kitchen / Serving areas for EQ / NDLC
- 7) Repurpose space to expand cafeteria at EQ / NDLC
- 8) Expand Multipurpose space to allow for separate Cafeteria and Gymnasium functions at Victor Haen
- 9) Remodel restrooms for ADA accessibility

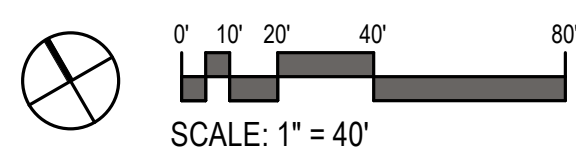

**eua** 

**RENOVATION AREAS**  
Redesign existing spaces to improve function

**NEW CONSTRUCTION AREAS**  
Expand building footprint to create new space